

Second Redesign of the
Studio Space

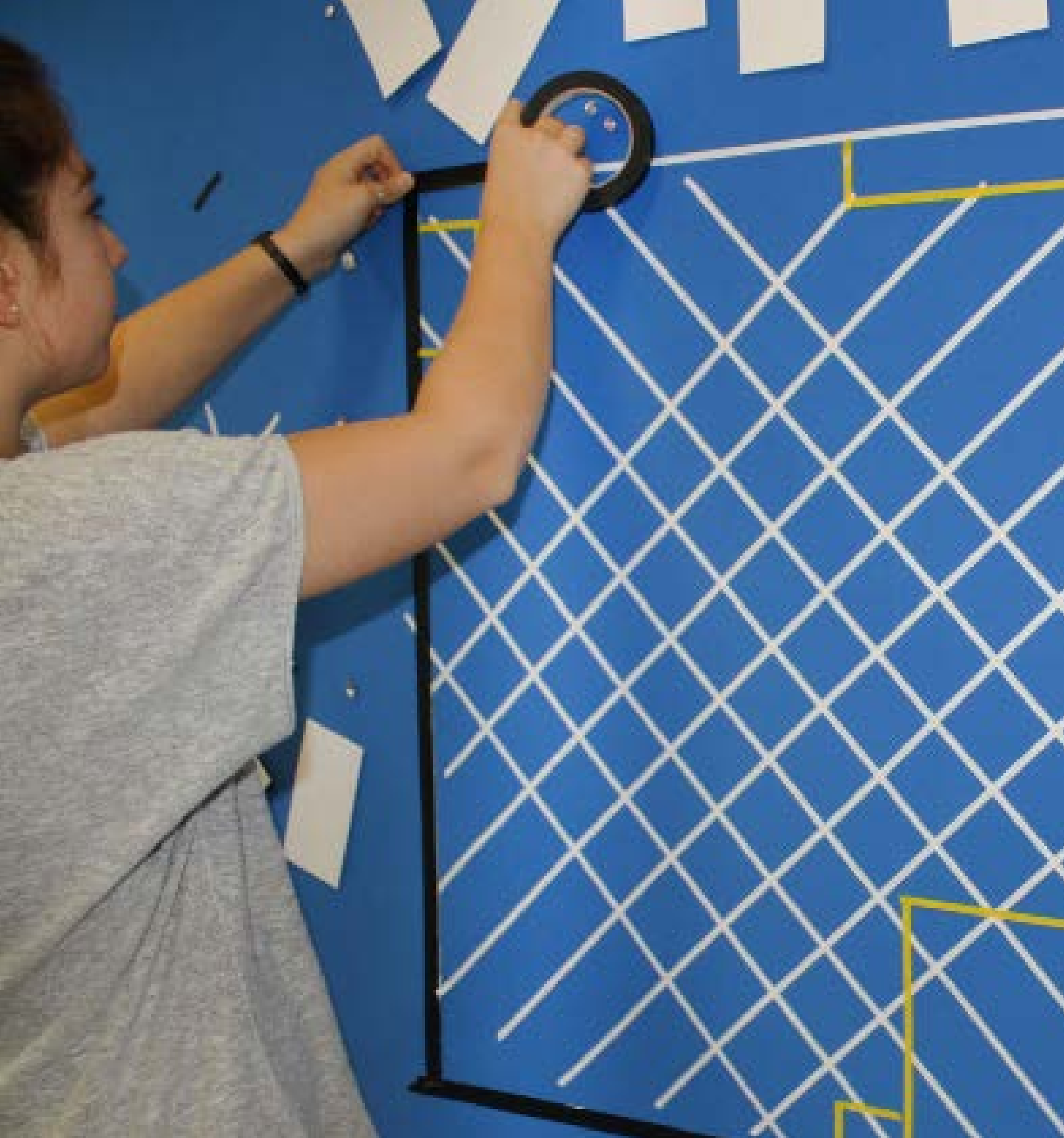

Working with the Wall

We wanted to experiment with the velcro wall so we decided to move out of SketchUp and start using our hands with physical models. Lia advised us to use different kinds of grid systems to find new ways to orient the furniture.

Initially we made the grid on a 45 degree angle and then decided to move to a less rigid format with a more acute angle (approx 30 degrees). Working with the paper desks was much easier than using SketchUp and allowed us to iterate quickly, taking photos of each iteration along the way.

We used the jewels to try and find paths through the space to see if it was easy or difficult to get to each desk in the space.

We tried some formats keeping all individual space, but we liked the layouts with collaborative or desk sharing the best. Thus we could have flexible use spaces and students who do not use the studio space after class would only have an in class space. Taking down the dividers became an integral part of this concept; however we ran into a lot of problems taking them down.

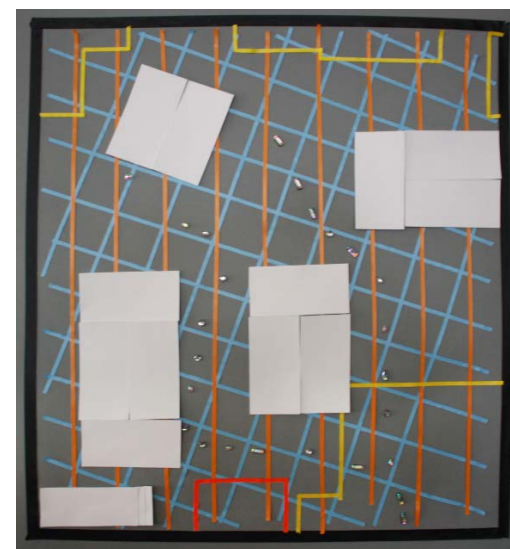
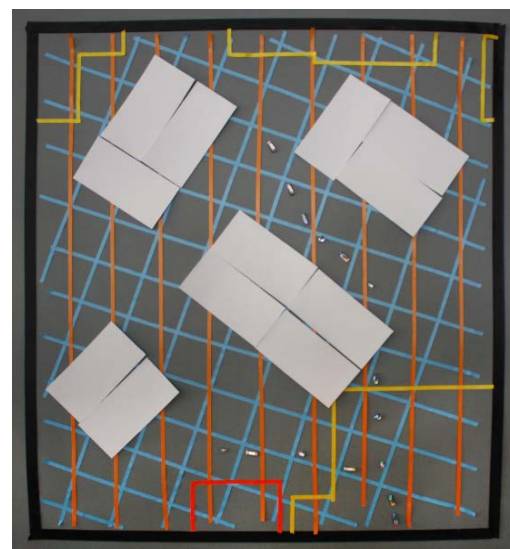
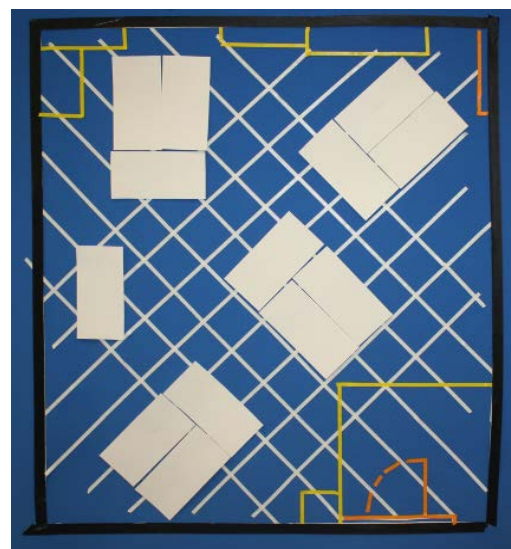
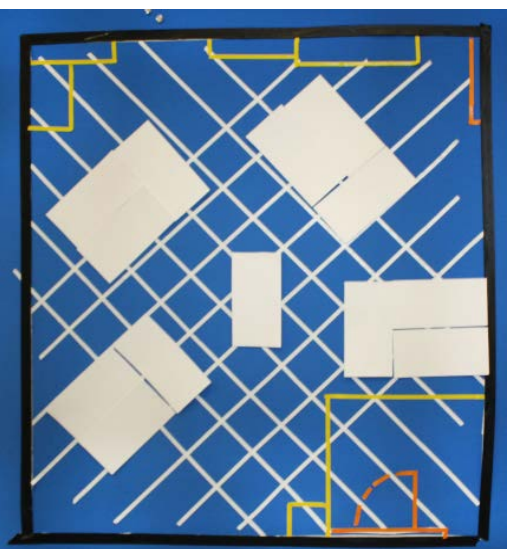
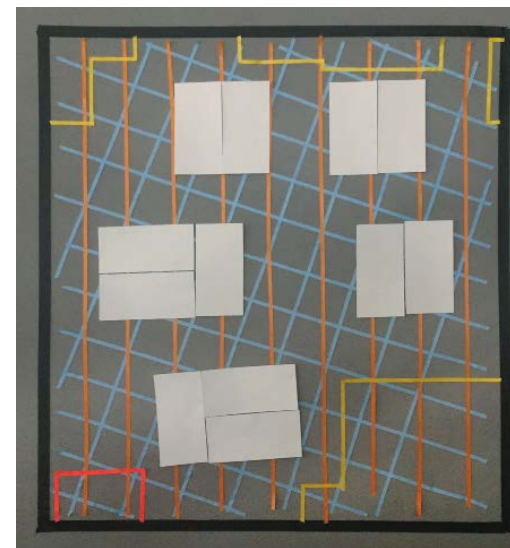
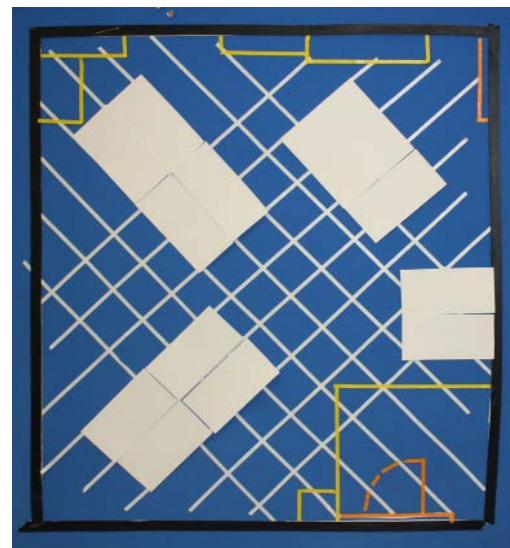
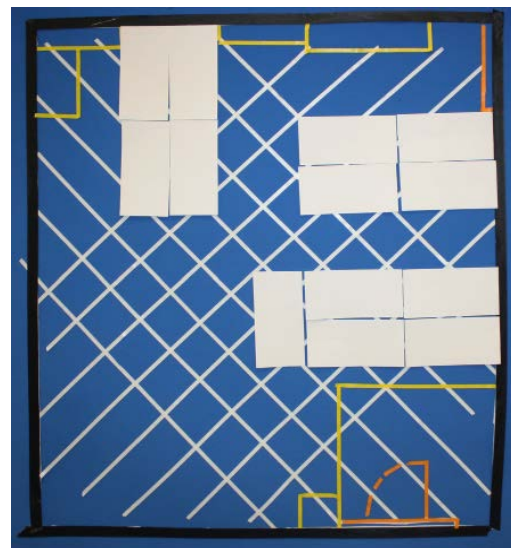
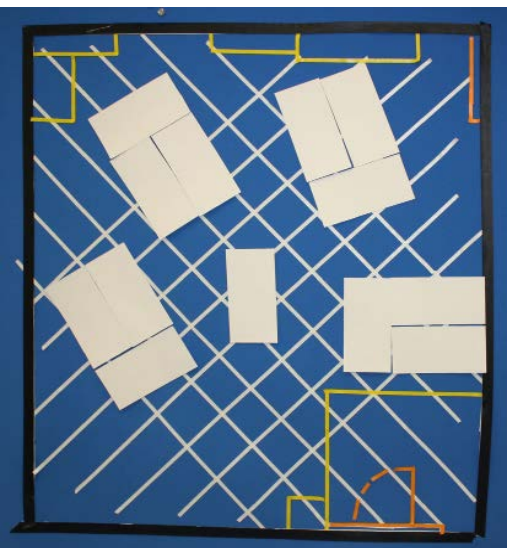
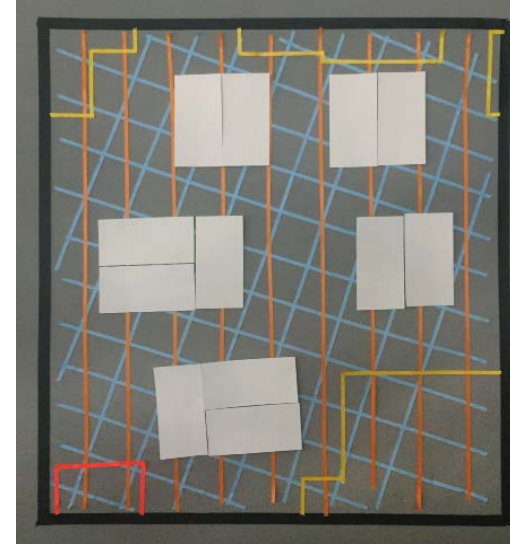
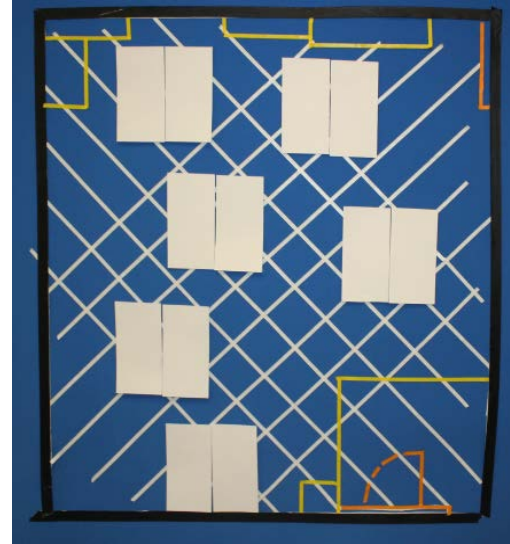
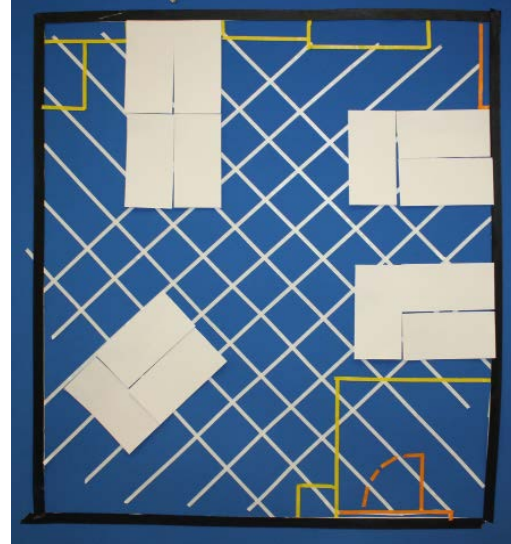
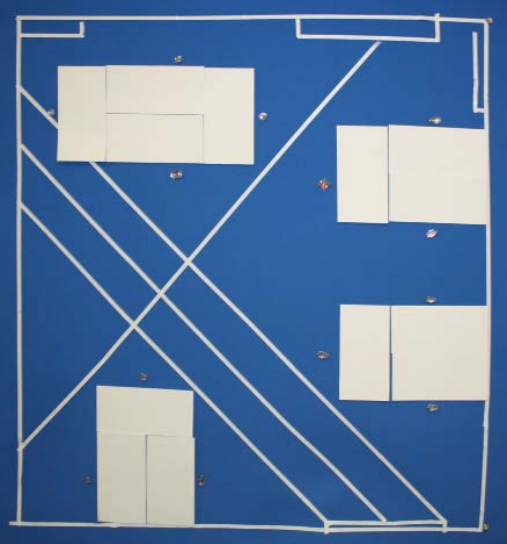

Iterations of
Spacial Layout

Second Layout





Initial Reactions

Smaller clusters allowed for a lot more room to move. Instead of having large clusters squished into the room, there are more smaller, reasonably sized clusters.

We didn't move Max's desk because he was not comfortable with all the change, so we chose a layout that wouldn't disturb him.

People who chose to not have a divider did not necessarily want to participate in desk sharing. Designers are really lucky to have their own spaces, so I think that this concept will be kept, but the option of a divider will remain. A lot of people are happy with them gone. It opens up the room and gives the illusion of more space.

The extra desk became a great place for prototyping. Many students used it for cutting cardboard.

We found that we did not need the extra folding table. Taking it out of the room gave us a lot more space as well.

The space was an improvement from the last iteration, but we are looking forward to getting more critique in class.

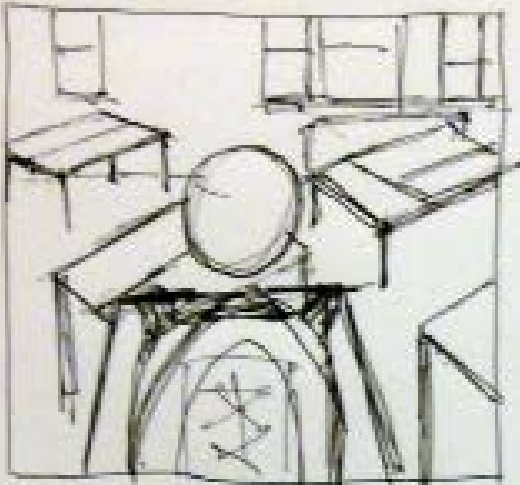

Student entering space for the start of the day.

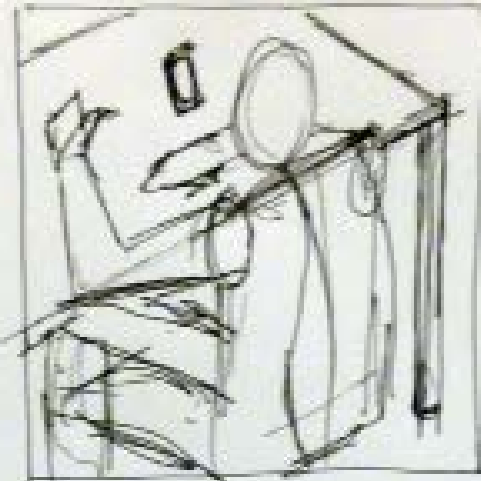

Working at their personal desk.

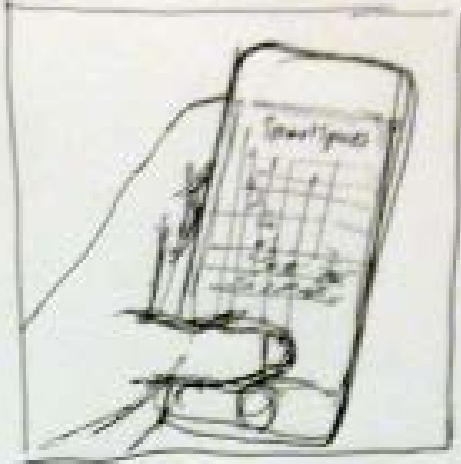

Tracking energy use throughout the day.

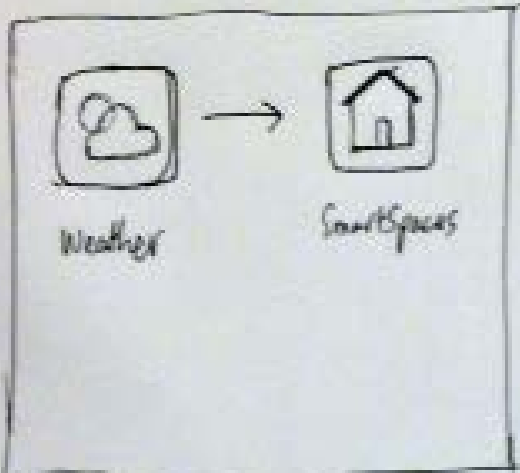

If its sunny out and shades are open, lights will turn off.

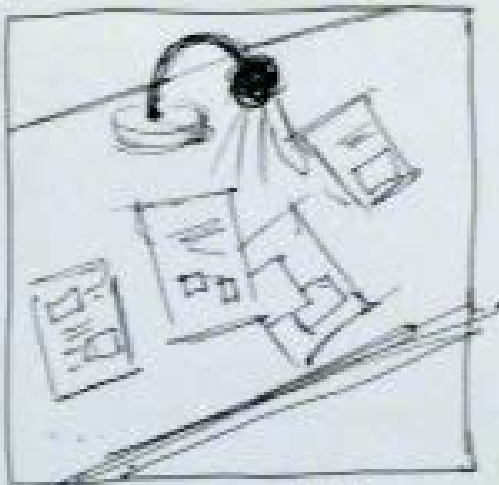

When light is left on after you leave reminder will be sent.

Storyboarding for Video

Trying to show how the different kinds of spaces we table sharing and personal can be tracked and analyzed for data collection.

Ideating for the Video

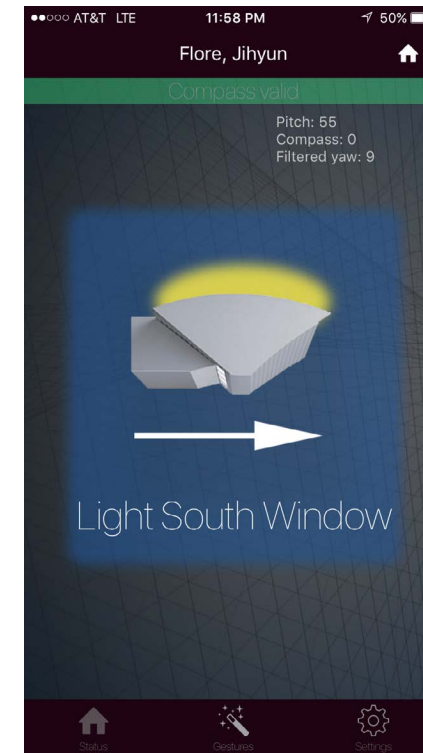
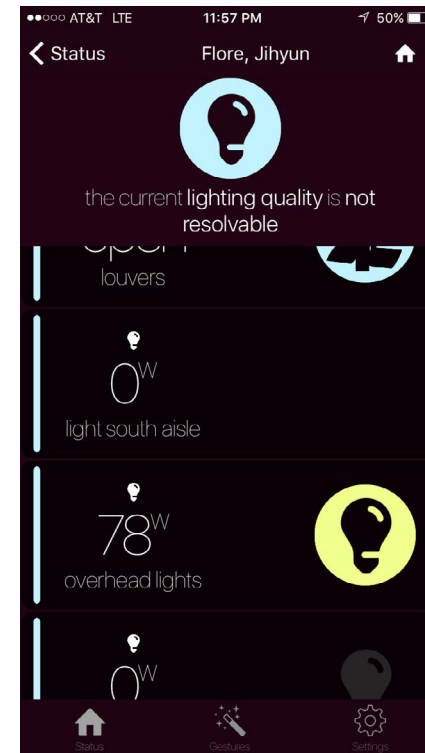
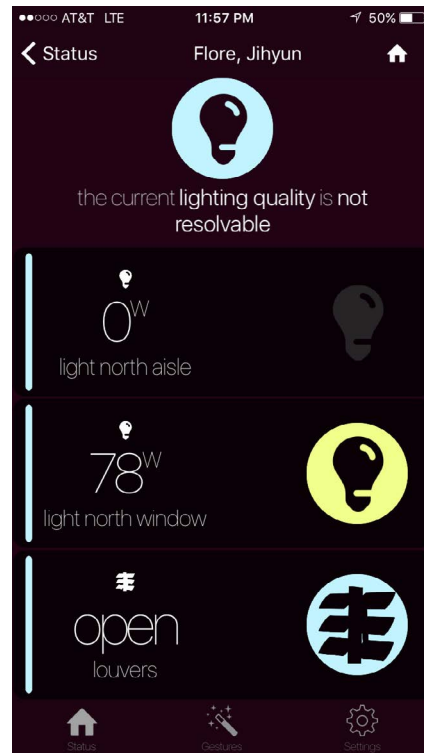
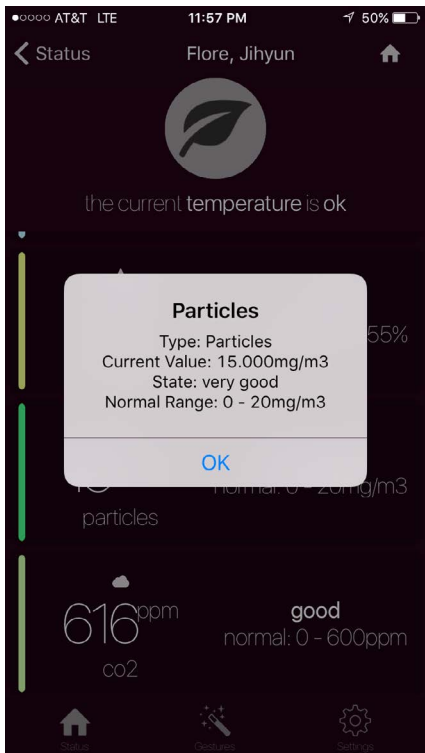
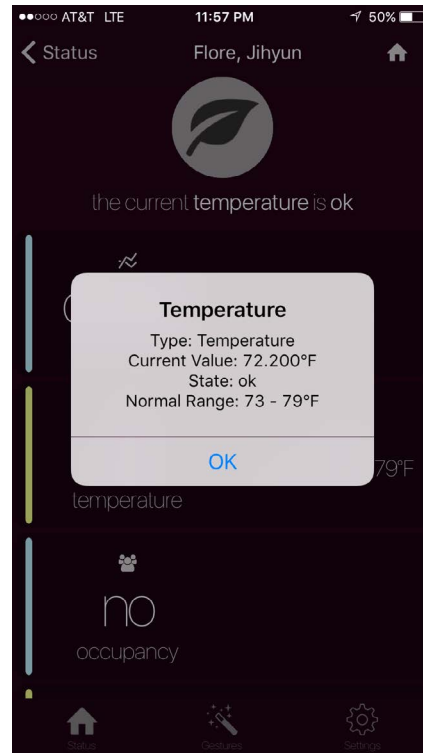
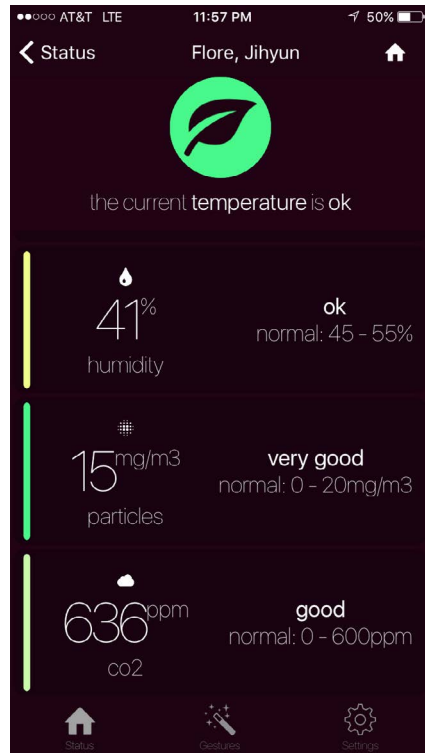
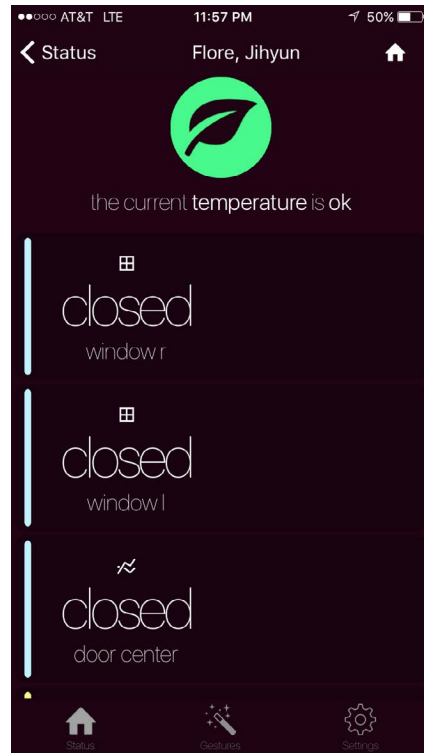
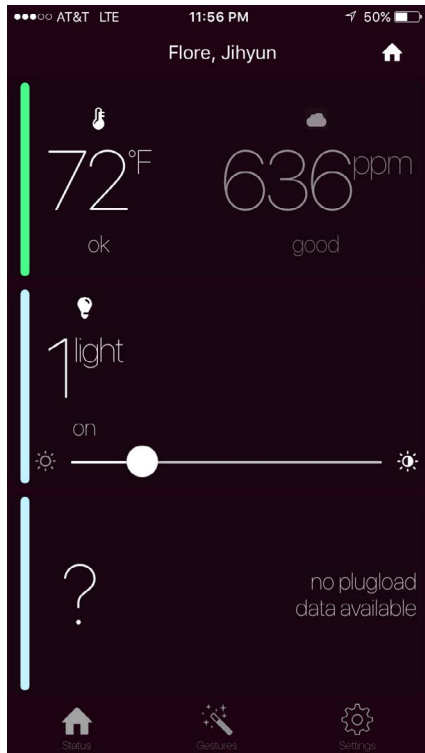

SmartSpaces Interface
app used in the Intelligent Workplace

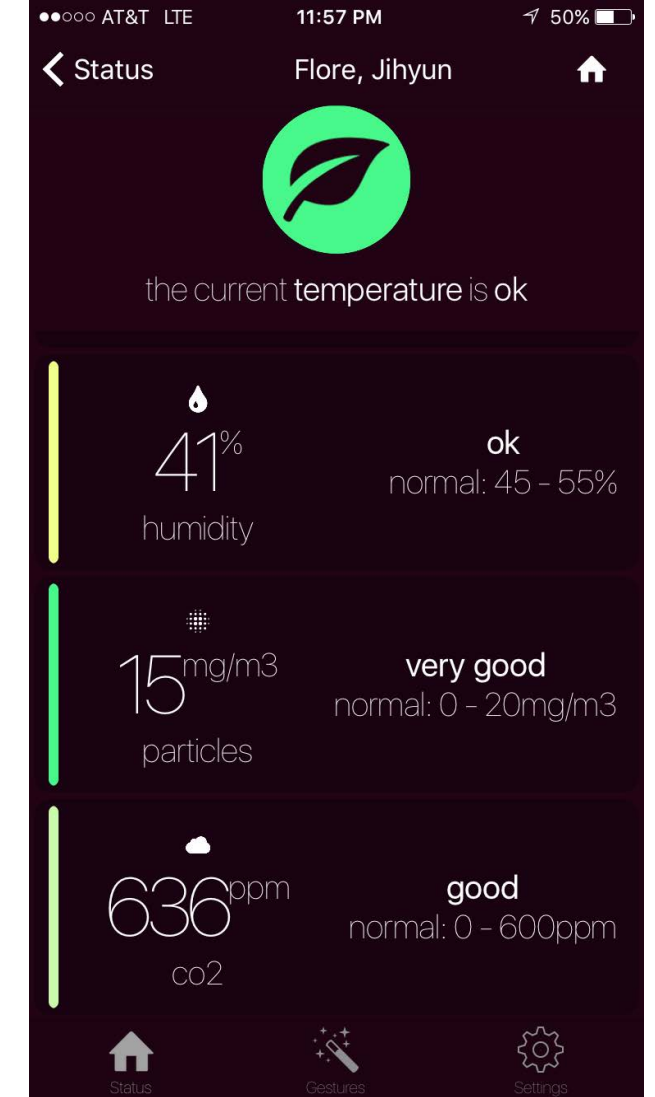
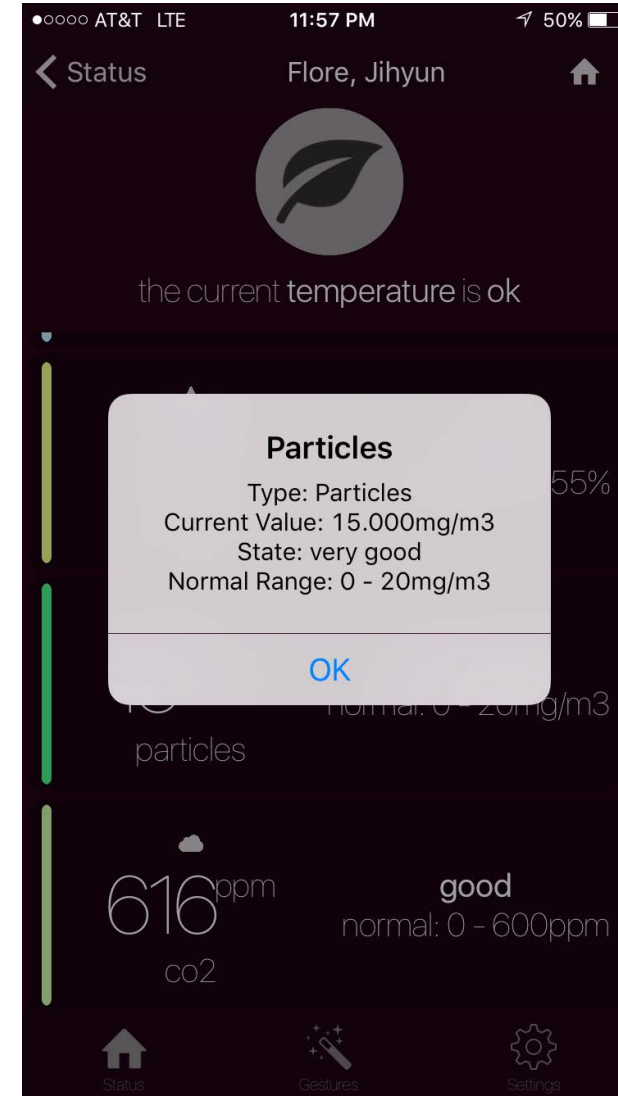
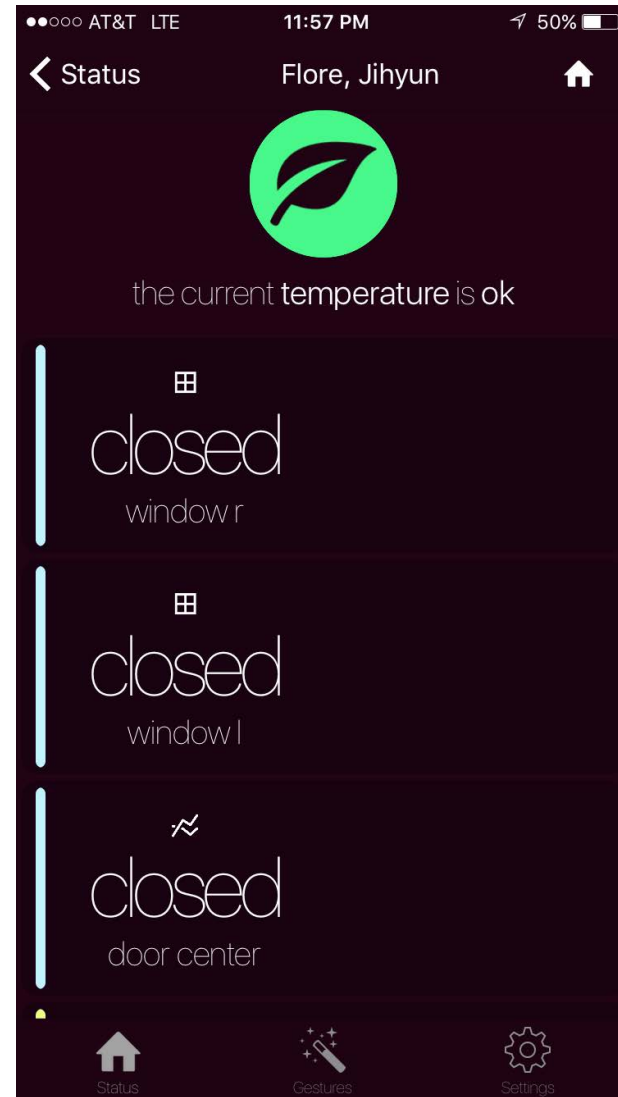
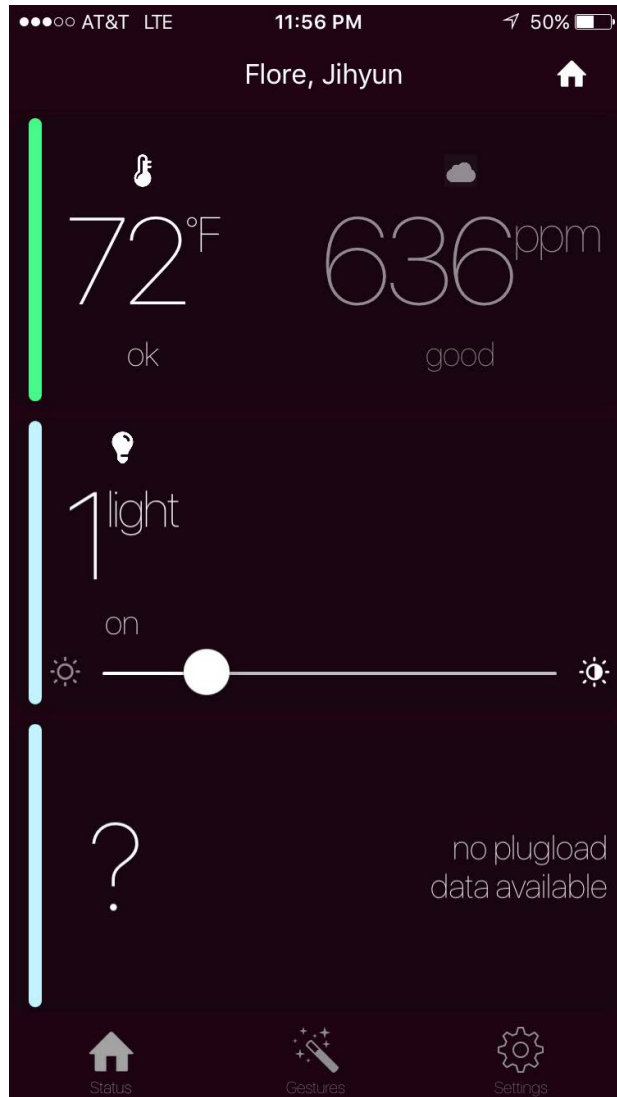

SmartSpaces Interface

a close up view of the main screen, temperature controls, air quality, window monitoring, etc.

Lighting Is Only the Beginning

Going far beyond lighting, Enlighted systems give you unparalleled control over the spaces you manage, increasing efficiency and making you smarter about virtually everything.

[Watch the Video](#)

How it works



Sensors

Enlighted Advanced Sensors are connected to each light fixture in the building and collect occupancy, ambient light, temperature and energy consumption data.



Gateway

The Enlighted Gateway aggregates data from individual Smart Sensors and sends it to the Energy Manager for analysis.



Energy Manager

The Energy Manager provides a secure interface to adjust settings, monitor and analyze energy savings and other data collected by the sensor network.



Real-time Data

Enlighted translates data from the sensor network into detailed energy, temperature, and occupancy insights around the clock.

[Learn More](#)

We actually have a control system for the lights in studio



Take Control of Your Space

Enlighted Room Control is a lighting remote control or wall-mounted device that lets people change illumination levels and configurations with the touch of a button. Building occupants and managers can dynamically adjust lighting levels to save energy, increase comfort or tailor illumination for specific tasks. Choose from pre-programmed settings through the browser-based software interface or customize settings with a few clicks of a mouse. A single Room Control device can manage up to 100 Enlighted-enabled light fixtures. No remodeling and electrical work is required for installation.

[Download the Datasheet](#)

It just doesn't work...
....but what if it did?